



SAMUEL WOOD

34 Dahn Drive, Ludlow, Shropshire, SY8 1XZ

£850 Per Month





MANAGED BY SAMUEL WOOD. A modern property on a popular residential development. Recently redecorated throughout, with back garden and off road parking.



Two bedroom terraced house located on a modern residential development.

Accommodation having upvc double glazing and gas fired heating includes: reception hall, cloakroom, kitchen, living room, first floor landing, 2 bedrooms and family bathroom. Kitchen comes with built in electric oven and gas hob, space for a washing machine and upright fridge freezer.

The property benefits from driveway parking and enclosed rear garden.

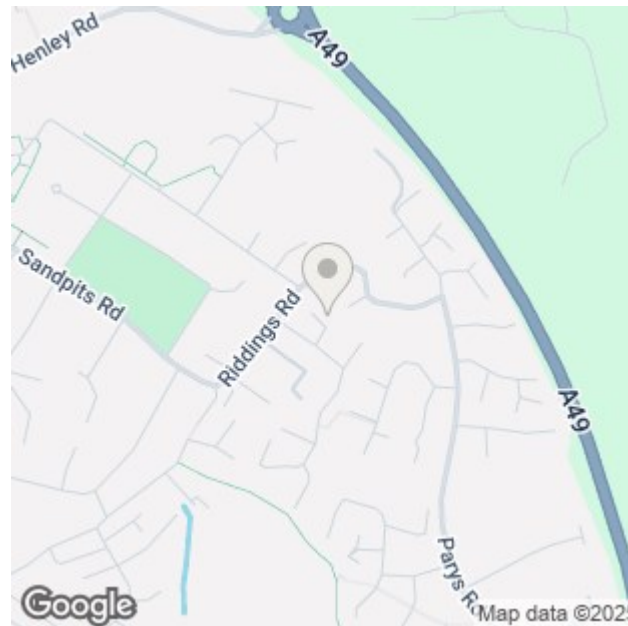

Floor Plans

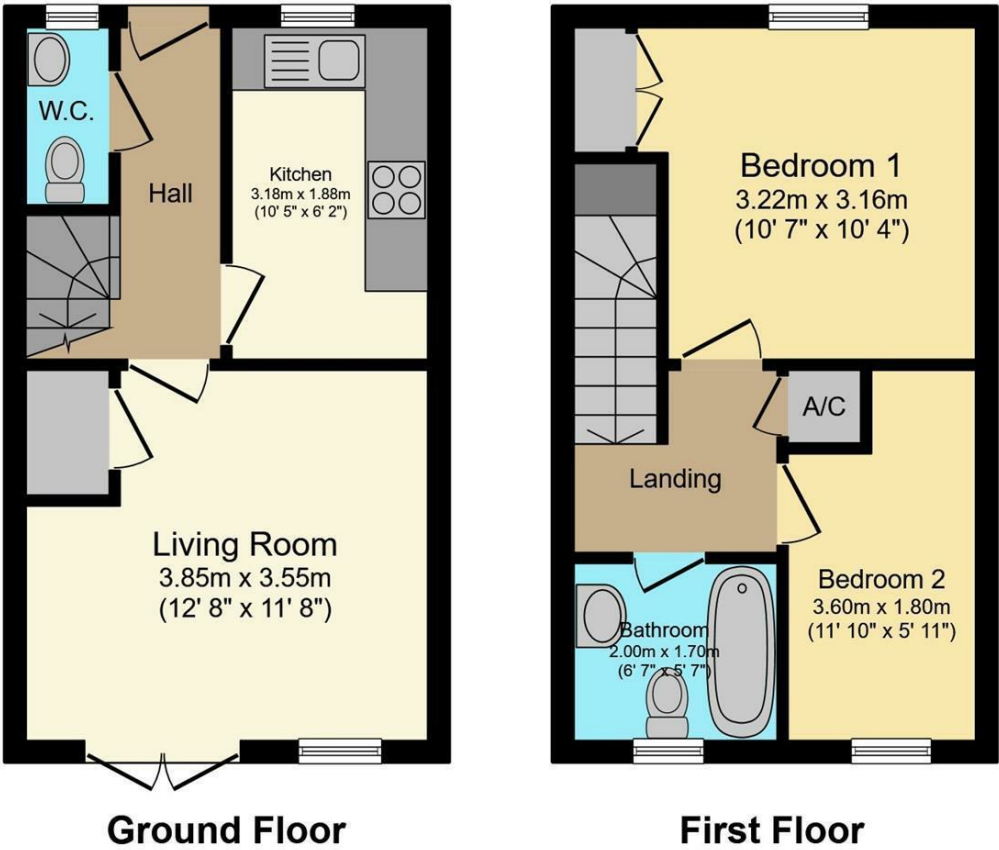

This Floor Plan is for illustration purposes only and may not be representative of the property. The position and size of doors, windows and other features are approximate. Unauthorized reproduction prohibited. © PropertyBOX

We take every care in preparing our sales details. They are checked and usually verified by the Vendor. We do not guarantee appliances, alarms, electrical fittings, plumbing, showers etc. You must satisfy yourself that they operate correctly. Room sizes are approximate; they are usually taken in metric and converted to imperial. Do not use them to buy carpets or furniture. We cannot verify the tenure, as we do not have access to the legal title; we cannot guarantee boundaries or rights of way so you must take the advice of your legal representative. No person in the employment of or representing Samuel Wood has any authority to make any representation or warranty whatever in relation to this property. If there is any point which is of particular importance to you, please contact the office and we will be pleased to check the information. Do so particularly if contemplating travelling some distance to view. Applicants are advised that the majority of our shots are taken with a wide angle lens.